

This quick start guide describes how to install and use the Industrial Media Converter. This is the Media Converter of choice for harsh environments constrained by space.

Physical Description

Front/Rear Panel

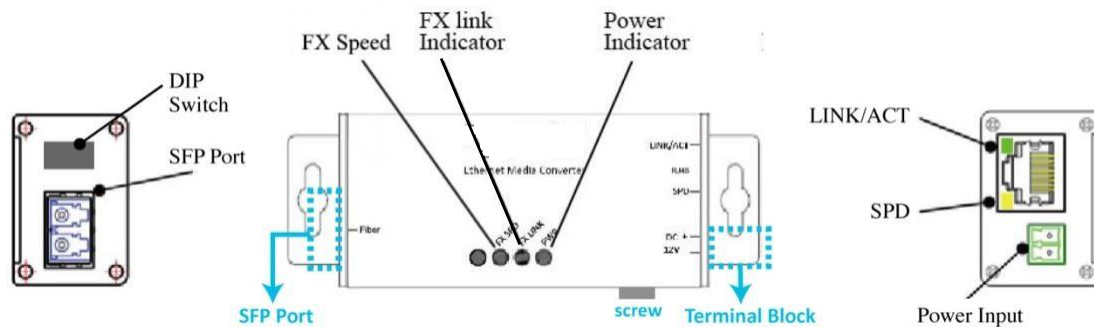

Installation

SFP Transceiver Module

You can select different SFP modules as required (Please refer to our SFP selection list for the appropriate module). To insert/remove the SFP, the procedures are as follow:

1. On the side panel, insert the SFP module into the SFP port until it is securely locked.
2. Connect the optical fiber (1/2 core) to the LC connector(s) of the SFP.
3. To remove the SFP module, press down the lock of the LC connector of the optical fiber to pull out the fiber cable.
4. Pull down the SFP lever and hold its position. Pull out the SFP module from the SFP port.

Setup

- a) Connect the Ethernet port of the media converter to a PC or network device with a network cable.
- b) Insert the appropriate SFP into the corresponding SFP port. Connect the fiber cable from the remote device (media converter or switch) to the LC connector of the SFP.
- c) After the device is powered on, the PWR indicator will all be on. If the indicators are not on, check the power supply connection.
- d) After all cables are correctly connected, the indicators will be lit as per port status LEDs (page 2).

Interface

Ethernet Port

RJ-45 Pin Assignment

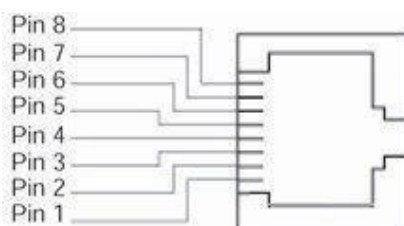

Pin	MDI Signal Definition	MDIX Signal Definition
1	TD+	RD +
2	TD-	RD-
3	RD +	TD+
4	NC	NC
5	NC	NC
6	RD-	TD-
7	NC	NC
8	NC	NC

Power Connection



- +

12VDC	-	GND	Terminal Block
	+	12V	

The Port Status LEDs, dimension drawing for the Micro unit

LED	State	Indication
PWR	Green	Power on.
	Off	Power off.
FX SPEED	Green	1000Base-FX
	Off	100Base-FX
FX LINK	Steady	A valid network connection established
	Flashing	Transmitting or receiving data. ACT Stands for Activity.
SPD	Yellow	1000Base-TX
	Off	100Base-TX
LINK/ACT	Steady	A valid network connection established
	Flashing	Transmitting or receiving data. ACT Stands for Activity.

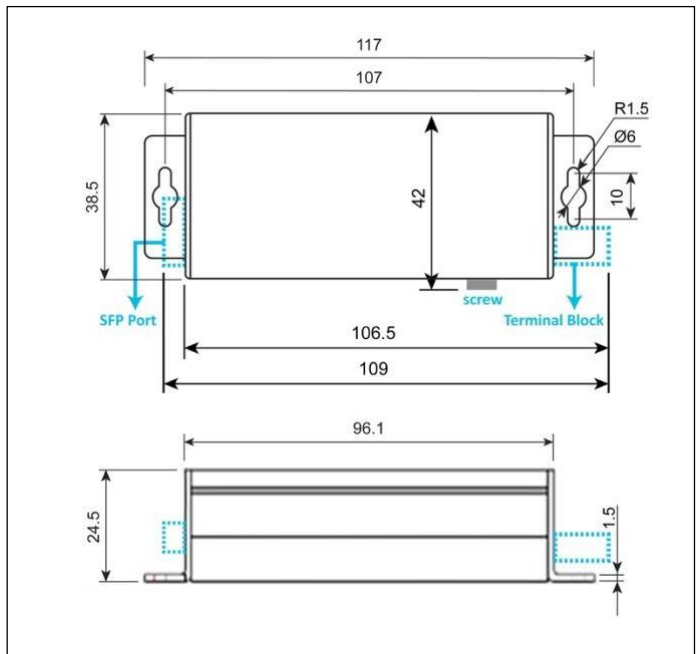

Introduction to DIP switches (If with dip)

NO	Function	Status	Description
1	LFP function	OFF	Disable
		ON	Enable
2	ALS function (only for SFP)	OFF	Disable
		ON	Enable
3	FX Reset	OFF	Disable
		ON	Enable
4	FX Speed Set	OFF	FX 1000M
		ON	FX 100M/1000M

When LFP is enabled, ALS is disabled automatically; When ALS is enabled, LFP is disabled automatically; When FX Reset is enabled, the MC will be rebooted when FX link is down.



HMC-HMT-G1S Micro Type Converter

Functional Description

- Converts 10/100/1000Base-TX to 1000Base-SFP
- Supports Full/Half-duplex
- Supports external 1000Base-SFP
- Supports Auto MDI/MDIX
- Sleek Microtype design, fits within most camera housing
- Extensive LED indicators for network diagnostics
- -40°C to 75°C (-40°F to 167°F) operating temperature

Assembly, Startup, and Dismantling

Installation

- Installation: Mount the Micro-type unit onto a fixture, or camera housings, e.g. a plank, (either on the wall or on a flat surface) with at least 2 screws piercing through the holes on the mounting frame to secure it in position.
- Startup: Connect the supply voltage to start up the Media Converter via the terminal block.
- Dismantling: Locate and remove the securing screws. Usually, but not limited to, at least 2 screws.